



PINEBEACH
BELEK



FACT SHEET

2022

pinebeach.com.tr



DISTANCES

| | |
|---------------------|--------------|
| Antalya airport | 33 km |
| Antalya city center | 45 km |
| Nearest town | 3 km (Belek) |
| Nearest hospital | 9 km |
| Nearest golf field | 2,2 km |



LOCATION AND GENERAL INFORMATION

| | | | |
|-------------------|--|--------------------|---|
| The name of hotel | PINE BEACH BELEK | Opening date | 2001 |
| Category | 5* Hotel | Last Renovation | 2022 |
| Area | 118.000m ² | Accommodation Type | Ultra All Inclusive concept |
| Location | İleribaşı Mevkii, 5. Parsel – 07506 Belek – Antalya – Turkey | Season | 12 months |
| Phone | +90 242 710 02 00 | Amount of rooms | 743 |
| Faks | +90 242 715 25 15 | Amount of beds | 1385 |
| Web Sitesi | www.pinebeach.com.tr | Air conditioning | heating and cooling– 24 hours central air conditioning system |
| E-mail | info@pinebeach.com.tr | Amount of floors | 5 floors at maing building, 4 floors at Club main building, 13 blocks of 2 floors bungalows |
| Transfer | 24 hours transportation services and a taxi station opposite the hotel | Amount of elevator | 6 (Main Building) |
| Languages | Turkish, English, German, Russian | Pets | not allowed |
| | | Internet/Wireless | inclusive |
| | | Credit cards | Master, Visa |



ACCOMMODATION

Common services offered to all rooms

- ◆ Key card system
- ◆ Daily refreshed minibar (water, coke, fanta, sprite, Efes beer)
- ◆ Smoking in rooms, all indoor and other public areas is prohibited by Turkish Government according to the Law of the Turkish Republic.
- ◆ Phone connection, internet, radio channels, safe box, central air conditioning system, hair dryer, LCD TV, kettle and tea&coffee set up, 220 V
- ◆ Slippers and bathrobe on request.
- ◆ 'Pillow of your choice' -service on request
- ◆ Iron on request.
- ◆ Special for babies: potty and baby bath tub on request
- ◆ Balcony.

| ROOM TYPE | SQUARE | FACILITIES | MAX.OCCUPANCY |
|-----------------------------|----------------------|---|---|
| CLUB STANDARD ROOM | 32,55 m ² | 282 rooms (4 disabled rooms) / Club area/ Garden view/ 1 bedroom (1 french bed or 2 twin beds), 1 bathroom (shower) | 2 adults + 1 child or 3 adults |
| MAIN BUILDING STANDARD ROOM | 34,6 m ² | 233 rooms (4 disabled rooms) / Main building / Garden view or Sea Side or Side Sea View/ 1 bedroom (1 french bed or 2 twin beds), 1 bathroom (shower). | 2 adults + 2 children or 3 adults + 1 child |
| JUNIOR SUITE | 48,2 m ² | 11 rooms/ Main building / Garden view or Side Sea View/ 1 bedroom (1 french bed) and 1 sitting room with interconnected door , 1 bathroom (shower) | 2 adults + 3 children or 3 adults +2 children |
| CLUB FAMILY ROOM | 65 m ² | 11 rooms/ Club area/ Garden view / 2 bedrooms (1 french bed or 2 twin beds) with interconnected door, 1 or 2 bathrooms /shower (upon availability) | 4 adults+ 2 children |



SWIMMING POOLS & BEACH

- ◆ 200 m long sand beach
- ◆ 1 pier
- ◆ Indoor pools opening hours 9am – 8pm, other swimming pools 8am – 6pm
- ◆ Aquapark (6 slides for adults and 2 for children). Opening hours 10am- 12.30pm 2pm – 5.30pm

| Swimming Pool | Outdoor | Indoor | Fresh water | Sea water | Heating | Depth (cm) | Area (m ²) |
|--|---------|--------|-------------|-----------|---------|------------|------------------------|
| Club swimming pool | ✓ | | | ✓ | | 140 | 288 |
| Club swimming pool | ✓ | | ✓ | | | 140 | 790 |
| Club children swimming pool | ✓ | | ✓ | | | 40 | 30,45 |
| Resort swimming pool | ✓ | | | ✓ | | 140 | 679 |
| Resort children swimming pool | ✓ | | | ✓ | | 40 | 22 |
| Botanic swimming pool | ✓ | | ✓ | | | 140 | 228 |
| Botanic children swimming pool | ✓ | | ✓ | | | 40 | 19 |
| Aquapark | ✓ | | ✓ | | | 120 | 252 |
| Aquapark (river) | ✓ | | ✓ | | | 140 | 220 |
| Aquapark (bowl) | ✓ | | ✓ | | | 160 | 46 |
| Aquapark children swimming pool | ✓ | | ✓ | | | 40 | 40 |
| Club indoor swimming pool | | ✓ | | ✓ | | 140 | 275 |
| Club children indoor swimming pool | | ✓ | | ✓ | | 40 | 10 |
| Resort indoor swimming pool (chargeable) | | ✓ | ✓ | | | 140 | 171 |
| Resort indoor swimming pool | | ✓ | | ✓ | | 140 | 101 |



PAVILION SERVICE

Pavilion: beach towels, mini bar, safe.

Buttler service: 10.00 – 18.00

10:00 Coffee, tea, cake

10:30 Cold mint towel

11:00 Fruit service

12:00 Lemonade service

13:00 Appetizer service

14:00 Cold lavender towel

15:00 Ice-cream service

17:00 Mohitos

In total 52 pavilions, chargeable



FOOD & BEVERAGE

- ◆ 2 Main restaurants, 3 A'la Carte restaurants, 3 snack restaurants, 9 bars, 1 waffle house, 1 patisserie, 1 children buffet
- ◆ Open buffet breakfast, lunch, dinner at main restaurant
- ◆ 'Sante'main restaurant capacity-800pax (500 pax indoor/300 pax outdoor). 'Pinea' main restaurant capacity- 560 pax (300 pax indoor/ 260 pax oodoor)
- ◆ Chidren buffet (cooking utensils for baby food), diet corner (main restaurant)
- ◆ Baby chairs (main restaurant)
- ◆ Premium alcohol (shampagne, bottle of wine, luxury alchohol drinks etc.) chargeable.

| | | |
|---------------------|---------------------------------------|--------------------|
| Breakfast | | 7 am – 10 am |
| Late breakfast | main restaurant | 10 am–11 am |
| Lunch | | 12.30 am – 2.30 pm |
| Dinner | | 6.30 pm – 9.30 pm |
| Akdeniz Snack | | 12 pm – 4 pm |
| Pool Snack | | 12 pm – 4 pm |
| Pool Snack (supper) | | 9.30 pm – 2.30 am |
| Ice-cream | at the beach / main outdoor pool area | 11 am – 6 pm |
| Patisserie | | 11.30 am – 6.30 pm |
| Gözleme | | 11 am – 6 pm |
| Waffle House | | 11 am – 6 pm |
| Aqua Snack | aqua park | 12 pm – 4 pm |
| Ice cream | | 10 am – 5 pm |



A'LA CARTE RESTAURANTS

| Name | Cousine | Place | Working hours | Capacity | Free | Chargeable |
|--------------------------|----------------------|---------------|---------------|----------|------|------------|
| Turca A'la carte | turkish cousine | main building | 7pm – 9.30pm | 45 pax | | ✓ |
| Mediterranean A'la carte | mediterraneancousine | main building | 7pm – 9.30pm | 45 pax | | ✓ |
| Fish A'la carte | seafood | akdeniz snack | 7pm – 9.30pm | 45 pax | | ✓ |

Reservation for A'la carte restaurants are made at Guest relations. There are baby chairs in A'la Carte restaurants

BARS

| Bar | OpeningHours | Included | Chargeable | Concept |
|----------------------|-------------------------------|----------|------------|--|
| Lobby Bar | 24 hours | ✓ | | All local alcohol & non-alcohol drinks and some import drnks (vodka, cognac, whiskey, irish cream liquor,vermouth, rum, sparkling wine and tequila) |
| Nautilus Bar | 10am – 12am | ✓ | | All local alcohol & non-alcohol drinks and some import drnks (vodka, cognac, whiskey, irish cream liquor,vermouth, rum, sparkling wine and tequila) |
| Antik Bar | 10am – 12am | ✓ | | All local alcohol & non-alcohol drinks and some import drnks (vodka, cognac, whiskey, irish cream liquor,vermouth, rum, sparkling wine and tequila) |
| Aqua Bar | 10am – 6pm | ✓ | | All local non-alcohol drinks, beer and wine |
| Pool Bar | 10am – 6pm 9.30pm – 2.30am | ✓ | | All local non-alcohol drinks, beer and wine |
| Botanic Bar | 10am – 6pm | ✓ | | All local non-alcohol drinks, beer and wine |
| Akdenz Bar | 10am – 4pm | ✓ | | All local non-alcohol drinks, beer and wine |
| Waterpipe& Disco Bar | 10am – 2am | ✓ | | All local alcohol & non-alcohol drinks and some import drnks (vodka, cognac, whiskey, irish cream liquor, vermouth, rum, sparkling wine and tequila) |

Milk is available at the lobby bar 24 hours. No bottle service of alcohol is available.



PINO MINI CLUB

- ◆ Pino Mini Club opening hours: 10am – 6pm
- ◆ Pino Club for children 4-7 years old, Pinny Club for 8-12 years old, Tinny Club for 13-17 years old
- ◆ Children 0-3 years old can enjoy the mini club under the supervision of an adult/parent
- ◆ Soft play, trampoline, play ground at shadow area
- ◆ Mini Club and activities: Playing garden, baking bread, cooking pizza, cooking cake, face and body painting, pirates day, olimpic days, happy birthday party and mini disco
- ◆ Pino garden, Pino Football Academy, Pino Swimming lessons (chargeable)
- ◆ Opening hours of mini club are subject to change.

VERY IMPORTANT BABY (ViB)

| | Services | Included | Chargeable |
|-----------------------|--|----------|------------|
| Reception | Baby strollers are given by deposit | ✓ | |
| Room | Baby beds, baby bath tub, potty (on request), toilet seat (on request) | ✓ | |
| Main restaurant | Children restaurant and buffet, children chairs, microwave, baby bottle sterilizer, blender, cacao and plain milk, fruit juices, baby food in jars (125gr), chicken and meat bouillon, boiled vegetables | ✓ | |
| Mini Club | Sleeping- and TV room, ice-cream service, mini kitchen (kettle, microwave, baby bottle sterilizer, milk) | ✓ | |
| Swimming pool & Beach | Playgrounds at the beach and swimming pool area | ✓ | |
| Room & Mini club | Private baby sitter service | | ✓ |



HONEYMOON CONCEPT

- ◆ Meeting with flowers, fruit plate and sparkling wine to the room on arrival day
- ◆ Bathrobe, slippers, a rose to the room and decoration of the bed
- ◆ In-room breakfast (once a stay upon request)
- ◆ Included A'la carte dinner (once a stay upon request)

ENTERTAINMENT AND ACTIVITIES

Included

- ◆ Disco (outdoor or indoor due to weather conditions / 11pm – 2am)
- ◆ Gym, aerobic, step, yoga
- ◆ Boccia, badminton, darts, streetball
- ◆ Air rifle gun, archery, beachvolley
- ◆ Table tennis (equipment)
- ◆ Sea bicycle, kano, windsurf (should be provide a certificate)
- ◆ Table Games- Room (playing cards, backgammon vs.)
- ◆ Mini football
- ◆ Mini cinema
- ◆ Tennis (2 hard courts and equipment)
- ◆ Day and evening animation, parties, shows

Chargeable

- ◆ Banana
- ◆ Jet ski
- ◆ Catamaran
- ◆ Ringo
- ◆ Windsurfing
- ◆ Parasailing
- ◆ Waterpipe
- ◆ Lightning of tennis courts
- ◆ Tennis lessons
- ◆ Game centre(PC games)
- ◆ Amerikan bilardo

OTHER SERVICES

Included

- ◆ Open parking (max. 100 cars)
- ◆ Towels, umbrellas, sunbeds and cushions at the beach and swimming pool areas
- ◆ Nurse (24 hours)

Chargeable

- ◆ Laundry / dry cleaning service
- ◆ Shops (Photographers, Silver shop, Jewellery, Watches, Brand shops, Proshop, Optical, Gift, Leather and Bag Boutique)
- ◆ Doctor (if needed)
- ◆ Internet cafe
- ◆ Phone and faks
- ◆ Photocopying
- ◆ Spa & Wellness services
- ◆ Medworld Thalasso & Rehabilitation Center



MEETING ROOMS

A Meeting room

| Name | Width m | Lenght m | Heightm | Spacem2 | Theatre | Class | Banket |
|---------------|---------|----------|---------|----------|---------|-------|--------|
| A - 1 | 13,00 m | 25,00 m | 5,00 m | 325 m2 | 250 | 140 | 140 |
| A - 2 | 14,00 m | 25,00 m | 5,00 m | 350 m2 | 380 | 200 | 220 |
| A - 3 | 13,00 m | 25,00 m | 5,00 m | 325 m2 | 250 | 140 | 140 |
| A 1+2+3 Total | 25,00 m | 40,00 m | 5,00 m | 1.000 m2 | 1100 | 550 | 700 |
| A - 4 | 4,90 m | 10,82 m | 4,70 m | 53 m2 | 40 | 30 | 30 |
| A - 5 | 12,50 m | 12,00 m | 3,66 m | 150 m2 | 100 | 70 | 80 |
| A - 6 | 7,70 m | 17,53 m | 3,60 m | 135 m2 | 120 | 85 | 90 |
| A - 7 | 4,95 m | 7,68 m | 3,60 m | 38 m2 | 35 | 25 | 20 |
| A - 8 | 5,70 m | 7,02 m | 3,00 m | 40 m2 | 30 | 25 | 20 |
| A - 9 | 5,16 m | 7,75 m | 3,60 m | 40 m2 | 25 | 22 | 20 |
| A - 10 | 7,77 m | 9,65 m | 3,81 m | 75 m2 | 45 | 40 | 50 |
| Foyer A | | | 3,80 m | 1.200 m2 | | | |



MEETING ROOMS

B Meeting room

| Name | Width m | Lenghtm | Heightm | Spacem2 | Theatre | Class | Banket |
|---------------|---------|---------|---------|----------|---------|-------|--------|
| B - 1 | 20,33 m | 33,20 m | 7,00 m | 675 m2 | 750 | 350 | 385 |
| B - 2 | 30,27 m | 33,20 m | 7,00 m | 1.005 m2 | 1.110 | 500 | 600 |
| B - 3 | 19,28 m | 33,20 m | 7,00 m | 640 m2 | 700 | 330 | 385 |
| B 1+2+3 Total | 33,20 m | 69,88 m | 7,00 m | 2.320 m2 | 2.575 | 1.500 | 1.650 |
| B - 5 | 4,95 m | 7,40 m | 3,70 m | 38 m2 | 40 | 30 | 30 |
| B - 6 | 4,85 m | 5,23 m | 3,70 m | 25 m2 | 25 | 18 | 20 |
| B - 7 | 4,85 m | 12,40 m | 3,70 m | 60 m2 | 40 | 30 | 30 |
| B - 9 | 4,85 m | 11,05 m | 3,70 m | 54 m2 | 25 | 20 | 20 |
| B - 10 | 5,10 m | 9,15 m | 3,70 m | 47 m2 | 40 | 30 | 40 |
| B - 11 | 5,90 m | 8,60 m | 3,70 m | 50 m2 | 35 | 25 | 20 |
| Terrace | | | 2,80 m | 3.500 m2 | | | |
| Foyer B | | | 6,37 m | 780 m2 | | | |

C Meeting room

| Name | Width m | Lenght m | Height m | Space m2 | Theatre | Class | Banket |
|---------|---------|----------|----------|----------|---------|-------|--------|
| C - 1 | 13,00 m | 25,00 m | 3,75 m | 310 m2 | 250 | 140 | 140 |
| C - 2 | 14,00 m | 25,00 m | 3,75 m | 380 m2 | 380 | 200 | 220 |
| C - 3 | 13,00 m | 25,00 m | 3,75 m | 310 m2 | 250 | 140 | 140 |
| Foyer C | | | | 220 | | | |

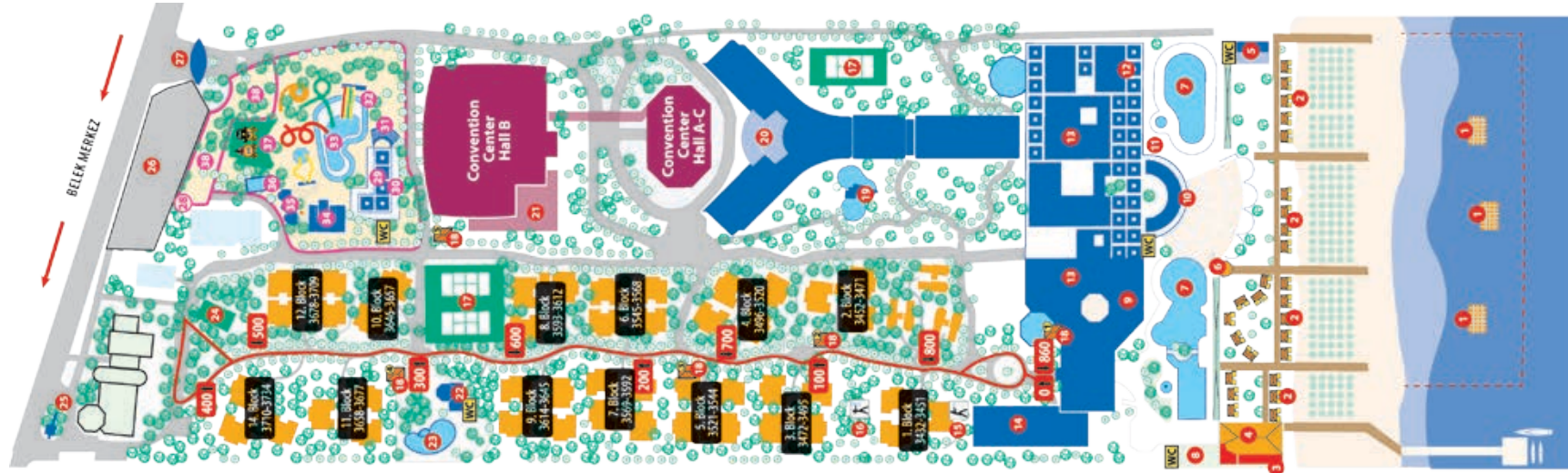

CHILDREN & TEENAGER WORLD 9.500 m²



- 29 Pino Snack
- 30 Pino Club
- 31 Pino Amphitheatre
- 32 Pino Crazy River
- 33 Pino Aqua Park
- 34 Baby Game & Sleeping House
- 35 Pino Art Studio
- 36 Pino Fresh Pool
- 37 Pino Playground
- 38 Teenager Fun Climbing Area

OUTDOOR PLACES

- 1 Sea Platform
- 2 Pavillion
- 3 Nargile Bar
- 4 Club Pine
- 5 Akdeniz Snack
- 6 Towel&Animation
- 7 Info Desk
- 8 Pool
- 9 Step-Aerobic
- 10 Pool Snack
- 11 Amphitheatre
- 12 Patisserie
- 13 A'la Carte Restaurants
- 14 Restaurants
- 15 Club Main Building
 - 1st Floor 3101-3119
 - 2nd Floor 3201-3221
 - 3rd Floor 3301-3321
 - 4th Floor 3401-3421
- 16 Air Rifle
- 17 Archery
- 18 Tennis Court
- 19 Bus Stop
- 20 Secret Garden
- 21 Reception
 - 1st Floor 1101-1146
 - 2nd Floor 1201-1286
 - 3rd Floor 1301-1390
 - 4th Floor 1401-1482
 - 5th Floor 1501-1576
- 22 Convention Snack
- 23 Relax Bar
- 24 Relax Pool
- 25 Green House
- 26 Staff Entrance
- 27 Parking Garage
- 28 Enterance



PINE BEACH
BELEK

CALL CENTER 0242 254 00 20

www.pinebeach.com.tr

    [pinebeachbelek](#)