

TITANIC BEACH LARA

# CONCEPT



**TITANIC**

---

BEACH LARA

# **TITANIC HOTELS**

Hotel management of AYG Corporate Group goes back to 1993 and the foundations of “TITANIC” brand were laid with the Ship-Shaped “Titanic Beach Lara” Hotel which has been put into service in Lara, Antalya in 2003.

With “Titanic Beach Lara” Hotel, AYG Group decided to expand and make investment in hotel management sector and due to the success of this new brand and the synergy it has created, the Group also decided to gather all its hotel business under the roof of “TITANIC” Brand and manage new hotels with this brand.

## **SUB-BRANDS OF TITANIC HOTELS**

AYG Group determines the sub-brands and concepts of the hotels invested and operated by the Group, managed under the roof of Titanic Hotels in accordance with the locations and physical structures of facilities.

The hotels of Titanic Hotels managed by the Group through its distinctive service approach in accordance with internationally recognized standards and long-years of experience are classified as follows.

### **PALACE HOTELS**

Palace Resort

Palace City

### **DELUXE HOTELS**

Deluxe Resort

Deluxe Golf

Deluxe City

### **BEACH RESORTS**

### **BUSINESS HOTELS**

### **PORT HOTELS**

### **CITY HOTELS**

### **COMFORT HOTELS**

## BASIC CHARACTERISTICS OF TITANIC HOTELS

The Best Location in its Category,  
Top-tier professional hotel management,  
Elite service approach focused on satisfaction of guests,  
First-class product guarantee for all kinds of products,  
Superior Food and Beverage concept in its category,  
Internationally recognized high Hygiene Standards,  
Sustainable Management Vision through Total Quality philosophy,  
High importance attached to the safety and health of guests,  
High Environmental Consciousness,  
Supporting and participating in social projects,  
Energy-friendly service approach,  
High-level, uninterrupted and free Wi-Fi service.

## PANDEMIC MEASURES OF TITANIC HOTELS

Due to the Covid-19 Pandemic taken hold of the whole world in the beginning of 2020, all facilities of TITANIC HOTELS have taken all measures for this pandemic and consequent similar cases in the shortest possible time.

The directives, recommendations and publications of the World Health Organization (WHO), the Health Ministries of the Republic of Turkey and the Federal Republic of Germany and all other related public institutions, sector agencies and Science Commissions are momentarily followed and the precautions are immediately taken.

Related with this, the “SAFE TOUCH” concept has been developed by reviewing the “Hygiene and Health Procedure” carefully implemented by the facilities of TITANIC HOTELS.

All our facilities have the “SAFE TOURISM” certificates issued by international audit institutions and these certificates are continuously kept up-to-date through regular inspections.



**TITANIC**  
HOTELS

ANTALYA | ISTANBUL | BODRUM | BERLIN



# TITANIC

---

## BEACH LARA

### GENERAL INFORMATION

Opening Date: May 2003

Category: Beach Resort 5-Star

Company: Aygün Turizm İnşaat San. Tic. A.Ş

Season: 12 Months

Total Space: 95.000 m<sup>2</sup>

Beach: 12.000 m<sup>2</sup> (Sand and turf)

Concept: Beach All Inclusive

Address: Kopak Çayı Mevkii, Lara / Antalya

Tel: +90 242 352 02 02 (03, 04)

Fax: +90 242 352 02 00

e-Mail: beachlara@titanic.com.tr

Web: titanic.com.tr



titanichotels



titanic\_hotels



titanichotels

### LOCATION AND ACCESS

Antalya City Center	12 km
Antalya Airport	10 km
Means of Access	VIP Transfer, Taxi, Bus

\* Pets not allowed.

\* Skateboard, Skate, Scooter, Hooverboard not allowed in indoor spaces of the hotel.

\* Drones not allowed.

\*\*\* Titanic Beach Lara reserves its right to make changes on the concept without informing any 2nd and 3rd party real and legal persons.

Titanic Beach Lara is located in Antalya/Lara, Lara Tourism Center, one of the most important holiday destinations of the World and Turkey. The hotel is on the beachfront of Lara beach, famous with its healing sands beyond comparison. The Hotel is 15 minutes to Antalya International Airport and 20 minutes to the city center and it is the most popular hotel of Lara Tourism Center.

Meeting and Congress halls, football fields, spacious rooms, large beach, being the most preferred and approved family hotel and the chance to enjoy your stay in all 12 months during a year are the most prominent characteristics of the Hotel.

## **CONCEPT**

For you, our esteemed guests, our BEACH ALL INCLUSIVE CONCEPT details for the services of the year 2021, carefully prepared for our "TITANIC BEACH LARA" Hotel in line with traditional Turkish Hospitality and long-years of experience of Titanic Hotels, are presented for your information.

## **WELCOME AND SENDOFF**

Doorman, Valet and Bellboy services	Free Parking Lot
Luggage Disinfection	Fever Check at the Entry Gate due to our Safe Touch Concept and Safe Tourism Certificate
Special Hygienic Welcome and Farewell Treats	Special reception for our handicapped guests
Hygienic and fast check-in and check-out procedures, general information about the facility	Hygienic room keys in dedicated container and facility guide presentation

## GUEST ASSISTANT SERVICE

An assistant is assigned to our guests staying in special room types (Colonel Suite, Admiral Suite, Deluxe Suite, Duplex Suite). Our guests can contact their special assistants in any issue to the check-out date.

## GUEST CALL CENTER

Our Guest Call Center serves all our guests between 08:00 and 00:00. During your check-in procedures, the contact number of our Call Center is provided to our guests and their GSM numbers are requested. After, registration processes, a "WELCOME" message is sent to our guests. This department responsible for fulfilling special wishes and requests of our guests, also shares regularly for our guests to take advantage from the amenities of our hotel at the maximum extent.

## VALID CREDIT CARDS

Visa	MasterCard	Eurocard	American Express
Installment option is only provided for the sales through our Call Center.			

## LANGUAGES

Turkish	English	German	Russian
Dutch	Arabic		

## SHOPPING

Shoes and Bags	Men & Women Boutique	Market	Jewelry
Gift Shop & Bijouterie	Kid's Boutique	Silver	Photograph
Sports Wear	Leather Shop		

## CHARGED SERVICES

Laundry and Dry Cleaning Services	Late Check-out and Early Check-in	Room Service	Premium and deluxe beverages out of concept
Import alcoholic drinks requested to be served with bottles	Vintage wines in A'la Carte Restaurants through Somalier presentation	Special daytime services and Cabanas at the Beach and the Swimming-Pools	Special night Services and Lodges at the Show Center
Stroller and Baby Radio	Wheelchair	Physician Services	SPA Therapy and Care Services
Photocopy and printer service	Luggage Wrapping Service		

## HONEYMOON CONCEPT

Based on availability of the Hotel The best room in the related category	Flowers in the room
Sparkling wine and Fruit plate at the check-in Cake and Turkish dessert plate	Special Bed Clothes
VIP Amenities set	Priority in A'la Carte reservations, Table decorations
20% discount in BeFINE SPA charged programs	

# ACCOMMODATION

## DETAILS OF ROOM TYPES

Room Types	Location	Properties	Max. Capacity
Standard Room	Main Building 26 m <sup>2</sup>	The Standard Rooms in the Main Building have 26 m <sup>2</sup> space, a twin or a French bed, sofa group, bathroom, minibar, TV, satellite and music broadcast, wireless Internet connection, direct phone, central air-conditioning, safety deposit box, shower, hairdryer, tea-coffee setup, carpet covered floors and a balcony. 7 of the Standard Rooms are designed for handicapped guests.	2+2 (3 adults)
Anex Standart Garden Room	Garden 26 m <sup>2</sup>	The Annex Standard Garden Rooms in the 2 Buildings inside the garden have 26 m <sup>2</sup> space, a twin or a French bed, bathroom, minibar, TV, satellite and music broadcast, wireless Internet connection, direct phone, central air-conditioning, safety deposit box, shower, hairdryer, tea-coffee setup, carpet covered floors and a balcony.	2+1
Anex Standard Swimming-Pool Room	Garden 26 m <sup>2</sup>	The lower floors of the Annex Standard Swimming-Pool Rooms in 3 buildings inside the Garden, which have 26 m <sup>2</sup> space are directly connected to the swimming-pool. There are a twin or a French bed, bathroom, minibar, TV, satellite and music broadcast, wireless Internet connection, direct phone, central air-conditioning, safety deposit box, shower, hairdryer, tea-coffee setup, carpet covered floors and a balcony in the Anex Standard Swimming-Pool Rooms.	2+1
Anex Family Room	Garden 39 m <sup>2</sup>	Anex Family Rooms located in the two-storey annex building in the garden are located next to the ocean swimming pool and kiddy swimming-pool. There are a twin or a French bed, bathroom, minibar, TV, satellite and music broadcast, wireless Internet connection, direct phone, central air-conditioning, safety deposit box, shower, hairdryer, tea-coffee setup, carpet covered floors and a balcony in the Anex Family Rooms. Lower floor family rooms: There are 1 large bathroom, 1 parent bedroom and a secondary room connected with a communicating door with a bunk bed and a TV. Upper floor family rooms: There are 1 large bathroom, 1 parent bedroom and a TV and a secondary room connected with a communicating door with a two single beds for two children and a tea-coffee setup.	3+1
Junior Suite	Main Building 65 - 85 m <sup>2</sup>	The Junior Suites in the Main Building have 65 - 85 m <sup>2</sup> space, a French bed, sofa group, minibar, LCD TV, satellite and music broadcast, wireless Internet connection, direct phone, central air-conditioning, safety deposit box, shower, hairdryer, tea-coffee setup, carpet covered floors and a balcony.	3+1
Handicapped Room	Main Building 30 m <sup>2</sup>	There are a French bed, balcony, bedroom, sofa group, bathroom, minibar, TV, satellite and music broadcast, wireless Internet connection, direct phone, central air-conditioning and a safety deposit box in the 30 m <sup>2</sup> Handicapped Rooms of the Main Building. There is a shower and a hairdryer in the bathroom and the rooms are equipped with a tea-coffee setup and carpet covered floors. (The rooms designed in order to fulfill all needs of our physically handicapped guests are one in each floor and all hotel units can be easily accessed through the elevators. The room entrance and bathroom doorsteps are designed for easy access through a wheelchair.	2+1
Colonel Suite	Main Building 120 m <sup>2</sup>	The Colonel Suites in the Main Building have 120 m <sup>2</sup> space, a balcony, minibar, LCD TV, satellite and music broadcast, wireless Internet connection, direct phone, central air-conditioning, safety deposit box, shower, hairdryer, tea-coffee setup and carpet covered floors. Colonel Suites have seaview and they are made up of a living room, a bedroom with a king-size bed, a children room with a twin bed, 1 parent bedroom including a Jacuzzi, 2 WCs and 1 bathroom including a shower and a balcony.	5+1
Admiral Suite	Main Building 80 - 150 m <sup>2</sup>	One of the Admiral Suites in the Main Building with 80 - 150 m <sup>2</sup> space, has 2 rooms and the other one has 3 rooms. They are used as a single suite and separate rooms. There are a king size and a twin bed, minibar, LCD TV, satellite and music broadcast, Internet connection, direct phone, central Air-Conditioning, safety deposit box and tea-coffee setup in the Admiral Suites. There is a shower and a bathtub in the bathroom as well as a phone, Jacuzzi, parquet floors and a terrace.	5+1
Duplex Suite	Main Building 65 m <sup>2</sup>	There are 2 twin and 1 French beds in the duplex rooms of the main building There are also a sofa group, bathroom, Jacuzzi, minibar, TV, satellite and music broadcast, wireless Internet connection, direct phone, central air-conditioning, safety deposit box, shower, hairdryer, tea-coffee setup, carpet covered floors and a balcony in the Anex Standard Swimming-Pool Rooms.	3+1



# FOOD & BEVERAGES

## GENERAL INFORMATION ON BEACH ALL INCLUSIVE FOOD & BEVERAGES

High Hygiene Standards in all Services	Products produced from daily and fresh goods in all units	Branded and high quality, domestic and import products	24-Hours open Bar	Snack Restaurants with rich menus
Appetizers along with alcoholic beverage services	Cookies served with hot beverages at the Lobby and Lounges	Rich snacks	Rich Night Buffet	Carte Dor Ice-Cream and Waffle in specific hours
Minibars in the rooms with rich contents	Surprise treats to our regular guests and Club members	Birthday and Honeymoon treats	Beverage service at the swimming-pool to your sunbeds	Special custom food service for little guests

## MAIN RESTAURANT

Welcoming at the Entrance	Large and spacious indoor and outdoor space	Service from rich and high-quality open buffets at hygienic standards	Freshly-squeezed orange juice service in breakfast
A'la Carte Hot and cold beverage service during breakfast	Bakery products service in all meals	Pita varieties at lunch and diner	Hot and cold food services instantly prepared in all meals
Grilled Meat, Fish and Chicken in all meals	Instantly served fresh cheese and deli products in all meals	Rich Diet Buffet in all meals	Rich seafood buffet
Meat buffet prepared through a show in diners	Elite domestic and import alcoholic and nonalcoholic beverages	Vintage wines of specific brands	Various presentations from World Cuisine

## SNACK RESTAURANTS

Welcoming at the Entrance	Options from Snack Menus with Rich Alternatives	A'la Carte Service	Pita, Pancake, Bakery products at the Pidepan Restaurant
Kebab, Hamburger, Grilled Chicken and other Grills at the Beach Stella Snack Restaurant	High-quality domestic and import alcoholic and nonalcoholic beverages	Italian Sapore Snack Menu	

## PATISSERIE

Extensive patisserie showcase with lots of varieties	Daily fresh products prepared with high-quality ingredients	Self Service and A'la Carte Service	Hot and cold high-quality and branded nonalcoholic beverages
--	---	-------------------------------------	--

## A'LA CARTE RESTAURANTS

Reservation is necessary	Service fee is collected	Welcoming at the entrance and escort to the table	Atmosphere and decoration appropriate with the theme
You can select from the menu or A'la Carte Service	Unlimited elite alcoholic and nonalcoholic beverages	All wines are charged, an Extensive wine menu and somalier service	

## SERVICE HOURS OF FOOD AND BEVERAGE UNITS

### FOOD UNITS IN SUMMER SEASON

Restaurant	Service	Description	Opening - Closing	Concept
Parkfora	Open Buffet	Rich dishes from delicious world cuisine are served.	08:00 - 10:30 13:00 - 15:00 19:00 - 21:30	Beach All Inclusive
Kids' Buffet	Open Buffet	Baby Formula Microwave + mixer service	08:00 - 10:30 12:30 - 14:00 18:30 - 20:30	Beach All Inclusive
Beef Grill Club	A'la Carte	Steak and dry aged meat options are served.	19:00 - 22:00	Charged (29 Euro)
Pascarella	A'la Carte	Rich dishes from delicious Italian cuisine are served.	19:00 - 22:00	Charged (13 Euro)
Trot	A'la Carte	Daily seafood are served from the special showcase.	19:00 - 22:00	Charged (13 Euro)
Asia	A'la Carte	Options from the Asian cuisine are served.	19:00 - 22:00	Charged (13 Euro)
Pier Tavern (Wednesday)	A'la Carte	Traditional Turkish food and grilled tastes are served at the pier.	20:00 - 23:00	Charged (35 Euro)
Stella Snack Beach	A'la Carte	Bakery Products, Pita and Snacks Coffee Break	12:00 - 16:00 16:30 - 18:00	Beach All Inclusive
Italian Sapore Snack	Stella	Italian Menu	12:00 - 16:00	Beach All Inclusive
Midnight Snack	Special Mini Buffet	Fastfood varieties	24:00 - 03:00	Beach All Inclusive
Patisserie	Self Service	Hot and cold cakes, salty and sweet cookies, desserts and sandwiches	18:30 - 23:00	Beach All Inclusive
Ice-Cream / Waffle	Self Service	Solaris Bar	12:00 - 24:00 12:00 - 16:00	Beach All Inclusive
Room Service	A'la Carte	Foods and beverages selected from the menu.	24 hours	Charged (03:00 - 07:00 Foods Free)

## WINTER SEASON

Restaurant	Service	Description	Opening - Closing	Concept
Parkfora	Open Buffet	Rich dishes from delicious world cuisine are served.	08:00 - 10:30 12:30 - 14:30 18:30 - 21:00	Beach All Inclusive
Kids' Buffet	Open Buffet	Baby Formula Microwave + mixer service	08:00 - 10:30 12:30 - 13:30 18:30 - 19:30	Opened based on number of children.
Beef Grill Club	A'la Carte	Steak and dry aged meat options are served.	19:00 - 22:00	Charged (29 Euro)
Pascarella	A'la Carte	Rich dishes from delicious Italian cuisine are served.	18:30 - 22:00	Charged (13 Euro)
Trot	A'la Carte	Daily seafood are served from the special showcase.	18:30 - 22:00	Charged (13 Euro)
Asia	A'la Carte	Options from the Asian cuisine are served.	18:30 - 22:00	Charged (13 Euro)
Tavern Night	A'la Carte	Traditional Turkish food and grilled tastes	19:00 – 22:00	Charged (27 Euro)
Midnight Snack	Special Mini Buffet	Fastfood varieties	23:00 – 24:00	Beach All Inclusive
Cordelia Patisserie	A'la Carte Service	Cakes, salty and sweet cookies and desserts	16:00 – 24:00	Beach All Inclusive
Room Service	A'la Carte	Foods and beverages selected from the menu.	24 hours	Charged

## BARS SUMMER SEASON

Bar	Opening - Closing
Cordelia - Lobby Bar	24 hours open
Armonia - Pool Bar	18:00 – 24:00
Schiller Coffee Corner	08:00 – 12:00
Solaris-Pool Bar	10:00 – 24:00
Aqua Bar	11:00 - 18:00
Beach Bar	10:00 - 18:00
Vitamin – Indoor Swimming-pool Bar	10:00 - 19:00
Caprice – Lobby Bar	16:00 - 24:00
Submarine / Ocean Bar - Disco Bar	00:00 - 03:00
Queenstown Bowling – Bowling Bar	Closed
Caprice – Patisserie	18:30 - 23:00

## WINTER SEASON

Bar	Opening - Closing
Cordelia - Lobby Bar	24 hours open
Armonia - Pool Bar	(Closed)
Solaris-Pool Bar	(Closed)
Beach Bar (Tea and Coffee Machine)	10:00 - 16:00 (based on weather)
Vitamin- Indoor Swimming-pool Bar	10:00 - 19:00
Caprice - Lobby Bar	10:00 - 24:00
Queenstown Bowling – Bowling Bar	16:00 - 00:00
Patisserie Bar	16:00 - 23:00

**BEACH ALL INCLUSIVE BEVERAGE CONCEPT  
SUMMER SEASON**

Whiskies	Chivas Regal 12 YO	Jack Daniel's	Johnnie Walker Red Label	Johnnie Walker Black Label	Ballantine's	Jim beam
	J&B Rare	Jameson				
Vodkas	Absolut	Smirnoff	Gilbey's			
Gins	Beefeater	Gordon's	Gilbey's			
Romlar	Havana Club	Captain morgen				
Tequilas	Olmecca Blanco	Olmecca Gold	Mariachi			
Cognac	Courvoisier	Metaxa	Martel VS			
Starters	Yeni Raki Tekirdağ Raki	Efe Gold Raki Efe Yaş üzüm Raki	Vermouth Bianco Rosso Extra Dry	Garrone Bitter Fernet Branca	Campari Jagermeister	Lemoncello
Beers	Efes Pilsen	Miller				
Likörler	Kahlua	Malibu	Safari	Irish cream	Archer's	

**WINTER SEASON**

Whiskies	Ballantine's	J&B Rare	Kentucky	
Vodkas	Gilbey's	Absolut		
Gins	Gilbey's	Beefeater		
Romlar	Havana Club	Captain morgen		
Tequilas	Mariachi			
Cognac	Cognac VS			
Starters	Efe Gold Raki Efe Yaş üzüm Raki	Vermouth Bianco Rosso Extra Dry	Garrone Bitter Fernet Branca	
Beers	Efes Pilsen			
Liquors	Irish Cream	Safari	Malibu	Lemoncello

## BEACHES AND SWIMMING-POOLS

### BEACH

350 Meters Beach Seaside	Sunbeds and Awnings	Special Sunbath Decks	VIP Cabana Service (charged)	Lifeguard Service
Towel Service	Snack Restaurants, Patisserie and Bars at the Beach			

### SWIMMING-POOLS

Indoor and outdoor swimming-pools at different dizes with technological equipment

Swimming Pool	Outdoor	Indoor	Heated	Depth	Area m <sup>2</sup>
Indoor Swimming-pool		X	X	140 cm	170 m <sup>2</sup>
Indoor Kiddy Pool		X	X	30 cm	20 m <sup>2</sup>
Outdoor Main Swimming-pool	X			140 cm	4.500 m <sup>2</sup>
Olympic Swimming-pool	X			180 cm	1.250 m <sup>2</sup>
Semi-Olympic Swimming-pool	X			140 cm	315 m <sup>2</sup>
Aquapark Pool	X			105 cm	180 m <sup>2</sup>
Kids Slides Pool*	X			30 cm	750 m <sup>2</sup>
*Aquapark serves children over 6. Hours 10:00-12:30 & 14:30-17:00 Towel Desk 08:00 – 19:00					

### SLIDES FOR ADULTS

1 Black Hole 63 M	1 Rafting Slide 69 M
1 Turbolance Slide 72 M	1 Black Hole 62 M

### SLIDES FOR CHILDREN

1 Aqua Tower	1 Octopus Slide
1 Snake Slide	1 Wide Slide
1 Kids Body Slide	1 Kids Tunnel Freefall

## BEFINE SPA

Free	Fitness Center	Turkish Bath	1 steam room
	2 saunas	Snow room	Jacuzzi
	Resting room	Indoor Swimming-pool	Outdoor Swimming-pool
Charged	Massages and Bath Services	Skin and Body Care	

# TINI KIDS CLUB

Tini Kids Club presents, efficient communication with children and careful service and unlimited fun for children accompanied with its multilingual trainers.

## Facilities

For the children between 04 - 12 (children under 4 should be accompanied with one of their parents),  
12 – 17 Junior Club

Special shows prepared for children

Kid Shows

Children playground

Birthday celebrations

Special birthday celebrations (charged)

Packed Ice-Cream, Fruit Flavored Yogurt, Fruit Flavored Milk

\*Tini Kids Club service hours and locations vary based on seasons.  
Service hours in summer season are 10:00 - 13:00 and 14:30 - 17:30.

# ENTERTAINMENT & ACTIVITY

## DAYTIME ACTIVITIES

Morning Gymnastics and Water Gymnastics	Step & Aerobics	Boccia	Movie Theater
Latin and Oriental Dance Lessons	Basketball	Coffee, Card and Table Games	Football (Grass Field)
Beach Volley	Swimming-pool Games	Water Polo	Shooting
Bowling (Charged)	Game Machines (Charged)	Pool's Game (Charged)	

## NIGHT ACTIVITIES

World-famous show groups from different countries and acrobatic shows	Live music with orchestral accompaniment	Concept Parties	Karaoke
Ocean Disco	Submarine Club		

## WATER SPORTS

Free	Wind Suft (License is necessary)			
Charged	Scuba Lessons	Water Ski	Jet Ski	Canoe and Pedalo
	Parasailing	Special Swimming Lessons	Motorized Water Sports	

## SPORT CENTER

Sport Fields	<p>A sport complex outside the hotel with 4 grass Football fields (2 fields at 68 m * 105 m and 2 fields at 60 m * 90 m 2, parking-lot, 500 PAX tribune, 4 dressing rooms, 2 referee rooms, 1 physician room and 1 doping room)</p>	<p>1 grass football training field at 54 m * 90 m in the hotel</p>
	<p>4 tartan Tennis Courts</p>	<p>1 multipurpose fields</p>
	<p>Olympic Swimming-pool ( 50 m*25 m*1,80 m,10 swim lanes and diving board, lighted and special chronometer)</p>	<p>1 stretching field for gym groups.</p>
	<p>Football, basketball and tennis courts can be used by hotel guests for free.</p>	

## MEETING HALLS

Our meeting halls equipped with modern technology address all meeting groups and organizations with 1 large conference hall (1173 m2) which can be divided into 3 sections and 12 meeting halls in various sizes.

### ATLANTIC MEETING HALLS

# Atlantic

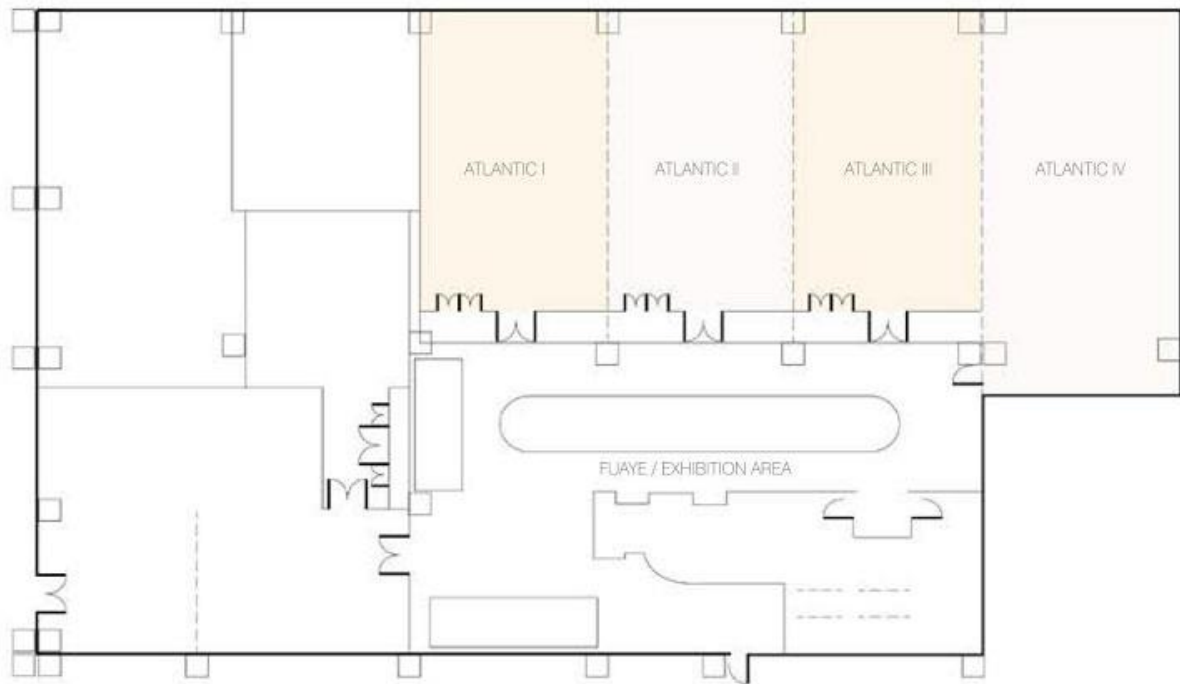

Meeting Halls	Area (m2)	Width (m)	Length (m)	Height (meter)	Banquet	Theater	Class	Cocktail
Atlantic I (Daylight)	90	7.4	12.2	2.6	-	80	50	-
Atlantic II (Daylight)	90	7.4	12.2	2.6	-	80	50	-
Atlantic III (Daylight)	90	7.4	12,	2.6	-	80	50	-
Atlantic IV (Daylight)	111	7.2	15.4	2.6	-	100	70	-

## PACIFIC MEETING HALLS

Pacific 

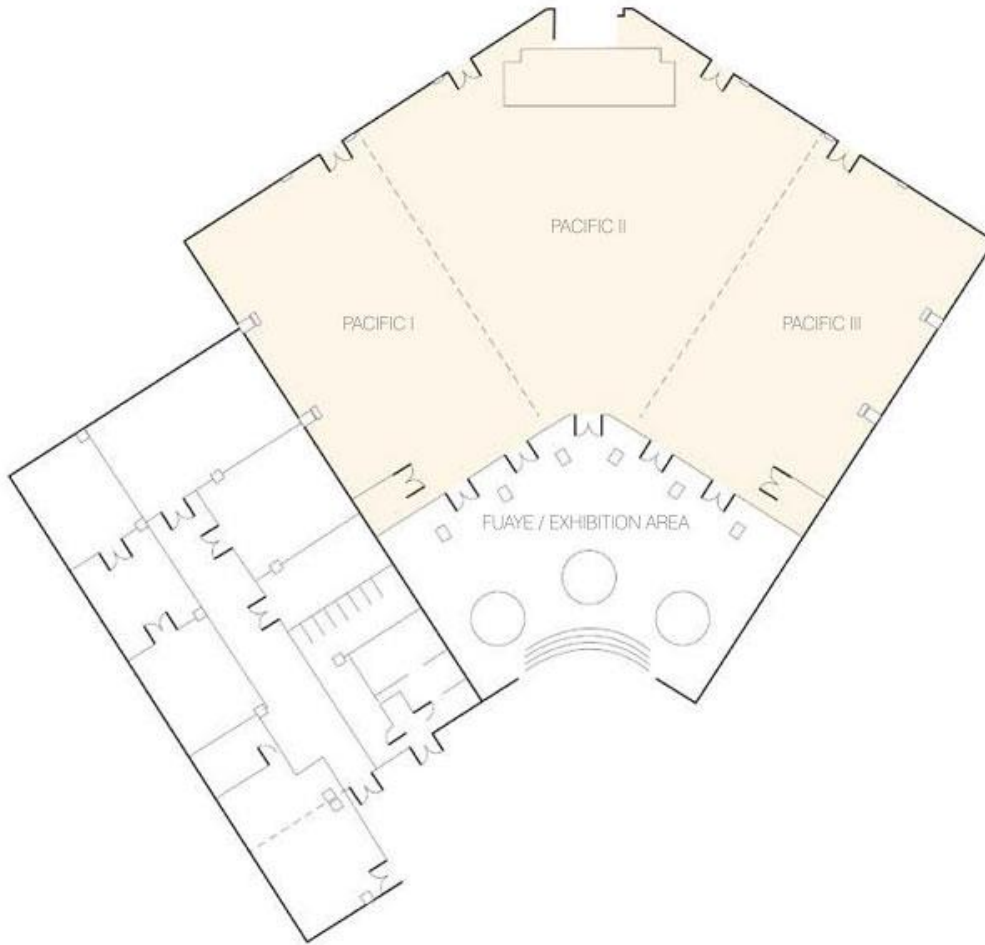

Meeting Halls	Area (m2)	Width (m)	Length (m)	Ceiling Height (m)	Banquet	Theater	Class	Cocktail
Pacific	1152	24	48	5.5	1000	1500	600	1500
Foyer	340	-	-	5	-	-	-	300
Pacific I	336	14	24	4.5	150	300	150	250
Pacific II	500	20	25	4.5	300	500	250	400
Pacific III	336	14	24	4.5	150	300	150	250

## BLACK SEA MEETING HALLS

# Black Sea

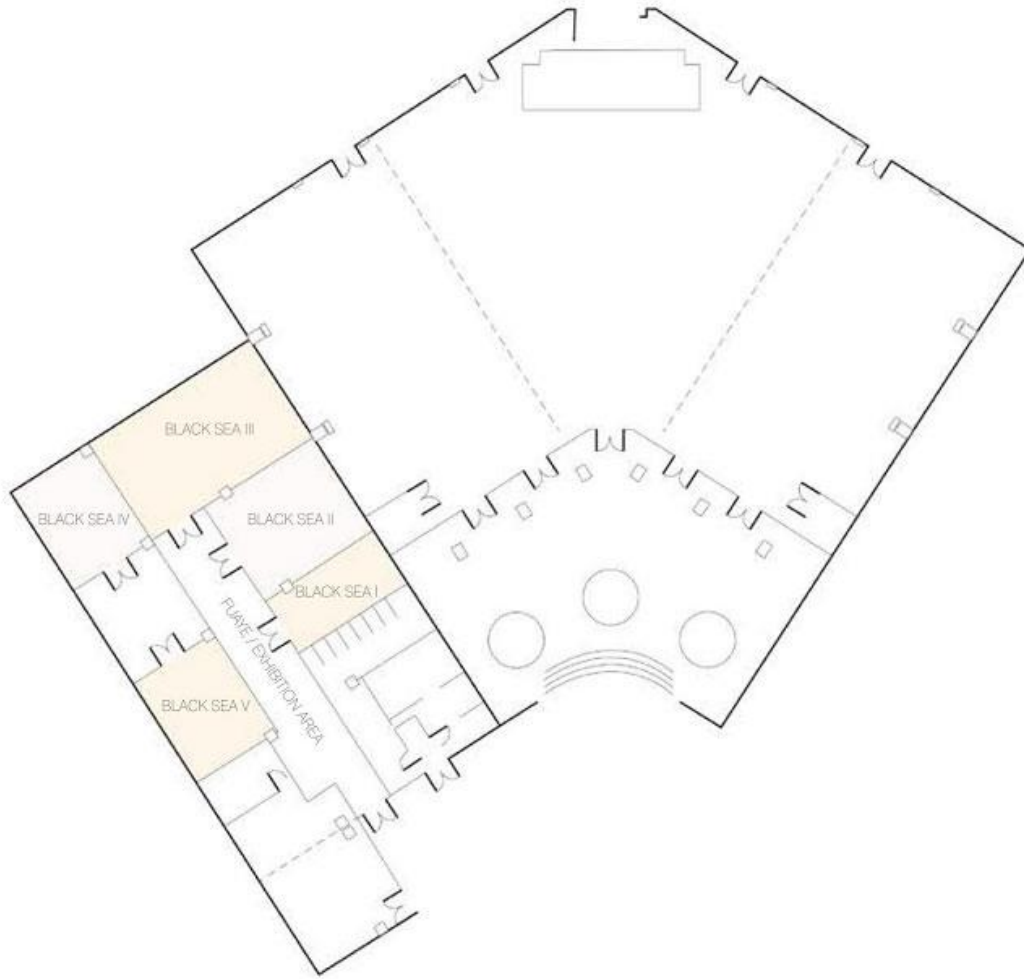

Meeting Halls	Area (m2)	Width (m)	Length (m)	Ceiling Height (m)	Banquet	Theater	Class	Cocktail
Black Sea I	30	3.9	7.8	4.4	-	20	12	-
Black Sea II	58	7.4	7.9	4.4	-	50	30	-
Black Sea III	88	7.4	12	4.4	-	90	60	-
Black Sea IV	44	7.4	6	2.6	-	40	20	-
Black Sea V	44	7.4	6	2.6	-	40	20	-

# CULLINAN LINKS GOLF CLUB

Cullinan Links Golf Club is the only golf course of Turkey which has both a river and the sea coast.

Cullinan Links Golf Club was renovated to 36 holes by "European Golf Design", the world's leading golf course design company.

Cullinan Links Golf Club offers golf lovers an illuminated Driving Range, the pleasure of playing with a 4-season golf vehicle and lessons from internationally certified golf instructors at the Golf Academy.

Official Opening	11 October 2021
Field Size	1.100.000 m <sup>2</sup> (110 hectares)
Opening Hours:	Summer Hours: 07:00 – 19:00 Winter Hours: 08:00 – 18:00 F&B ALL INCLUSIVE CONCEPT
Ordinary Wind Direction	In the morning from North (Taurus Mountains) and in the afternoon South (Sea Side)
Turf Type	In the summer: Paspalum. In the winter: Poa and lolium perenne.
Measurements:	Free pass marks are measured beginning from the Green. Green size is about 600 m2.
Field (Tee) Size	About 250 m <sup>2</sup> (White-Yellow-Red)
Bunker	Total 119 - Fairway Bunker 42
Green Bunker	77
Ponds	Total 10
Stream	Beşgöz Stream
Driving Range	36.000 m <sup>2</sup> 40 grass fields (105 m), 20 protected fields (105 m)
Putting Green	Total 5 –1 x 1042 m <sup>2</sup> (18 holes), 4 x 500 m <sup>2</sup> (9 holes)
Pitching Green	Total 2 Chipping Green 735 m <sup>2</sup> and 432 m <sup>2</sup>
Golf Carts	Total 64
Trolley	Total 240
Golf Bags for Rent	Left and right hand
Gold Lessons	Lessons are instructed at any level by PGA professionals.
Maximum Hcp.	Man 36 HCP, Woman 44 HCP

BERLIN

# TITANIC

## HOTELS

ISTANBUL

BODRUM

ANTALYA

TITANIC HOTELS

ANTALYA | ISTANBUL | BODRUM | BERLIN

titanic.com.tr

#MyTitanicStory

